

Tech Data

Viega Vision® for Style 10 Flush Plates Model 8315.1US



Viega Vision for Style 10 flush plates for Eco Plus® WC carriers are attractive and functional. The differently arched flush plate buttons for two volume flushing are easy to use.

Compatible With

- Carrier part number 52700 1.6/1.1 gpf 2x6 carrier
- Carrier part number 52710 1.6/0.8 gpf 2x4 carrier
- Carrier part number 52711 1.2/0.7 gpf 2x6 carrier
- Carrier part number 52712 1.2/0.7 gpf 2x4 carrier

Accessories

- Flush mount installation frame (part number 54935).



ADA Compliant

(Products marked with  comply with the American Disabilities Act (ADA) when installed per the requirements of the latest ADA Accessibility Guidelines (ADAAG) and/or ICC/ANSI A117.1)



This document is subject to updates. For the most current Viega technical literature please visit www.viega.us.



Viega products are designed to be installed by licensed and trained plumbing and mechanical professionals who are familiar with Viega products and their installation. **Installation by non-professionals may void Viega LLC's warranty.**

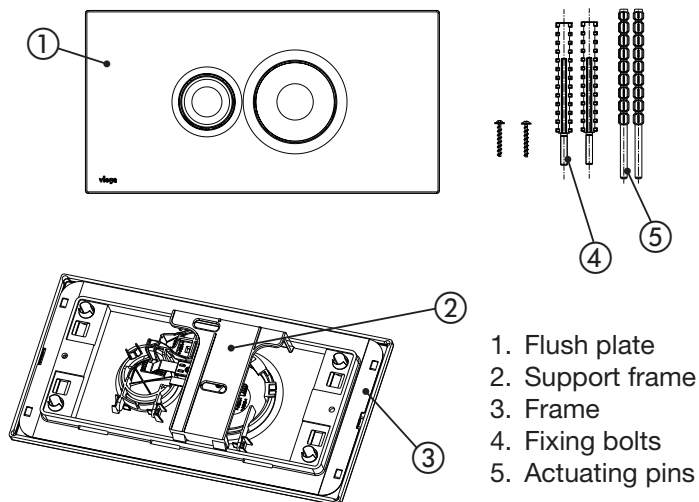

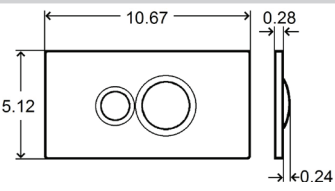
Name	Dimensions	Features and Components	Part No.	Material and Finish
Viega Vision for Style 10		Components: See figure above for all components	54635	Cover Plate: Plastic and Black Actuator: Plastic and Black
			54710	Cover Plate: Plastic and White Actuator: Plastic and White
			54715	Cover Plate: Plastic and Chrome Actuator: Plastic and Chrome
			54720	Cover Plate: Plastic and Matte Chrome Actuator: Plastic and Matte Chrome



Viega LLC

585 Interlocken Blvd.
Broomfield, CO 80021

Phone (800) 976-9819
www.viega.us

TD-FT 0620 Style 10 Flush Plates

viega